



BELMOND

AFLOAT IN FRANCE

BURGUNDY









CRUISING AT YOUR LEISURE

Explore some of the most enchanting regions of France from its great waterways. Enjoying all the comforts of a luxury barge, you drift past vineyards and fields of lavender to visit châteaux and tour vibrant towns.

T

he majestic vineyards of Burgundy, the medieval villages of Provence... All of this is yours to explore with Belmond

Afloat in France, a fleet of five luxury barges that drifts along the country's rivers and canals. This is cruising that allows the connoisseur to appreciate the beauty and culture of the French waterways to the full. On board you are offered every indulgence, from plunge pools to the finest cuisine; on land you can enjoy exclusive wine tastings and fascinating excursions. Whether you seek a family holiday, reunion with friends or a romantic escape, or perhaps share an interest in golf or photography, we can create the perfect journey with customised itineraries to realise your dreams.

Cruise along at your own pace and discover France's remarkable landscapes, welcoming people and delicious food and wine.

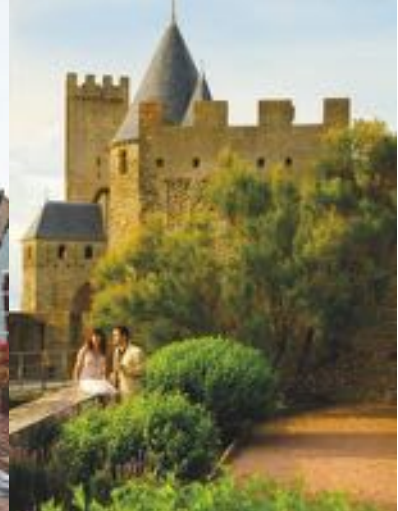



EMBARK ON THE DREAM

There are many ways to experience Belmond Afloat in France, from our **Inspiring Itineraries** and **Special Interest Cruises** to enhancing your stay with our **Extend the Experience** suggestions.

WHERE Along the scenic rivers and canals of southern France, winding through Burgundy, Provence and Languedoc-Roussillon and stopping at places of interest.

WHEN Live the dream on France's magnificent country waterways from April to October each year. If you are chartering, we can create unforgettable personalised itineraries tailored to suit your needs.

HOW You can book an entire barge (or two in tandem) for **private hire** for you and your group's exclusive use, or simply sail with us on a **per-cabin basis**.



FESTIVE FRANCE

Time your cruise to catch one of these great annual events.

April: **Festival Flamenco, Toulouse**

A week-long celebration featuring international artists.

May: Great Roman Games, Nîmes Dramatic re-enactments in the city's historic arena.

June: Carcassonne Festival Big names in theatre, music, opera and dance.

July: **Fête de la Lavande, Provence**

Scent-sational celebrations of the aromatic lavender harvest.

August: Fêtes de la Vigne, Dijon Live music and folk dances herald the coming harvest.

September: Besançon International Music Festival Long-running classical music event.

October: Nuit Blanche, Paris Dusk-till-dawn free-for-all of arts and culture.

Clockwise from top left: cycling is among a variety of diversions; visit charming towns en route; savour the convivial atmosphere on board.

LIFE ON THE WATER

Five lavish barges accommodate between four and 12 guests in sublime comfort. Our expert and unobtrusive crew members welcome you from the moment you arrive. This is cruising at the leisurely pace it deserves.

Drifting past superb scenery, enjoying a chilled glass of wine or a dip in your pool, alighting to play pétanque or golf, or even to visit a sumptuous château, this is the experience we create for you. All barges have a high crew-to-guest ratio where our seasoned crew members are bilingual in English and French, so you know you'll be well looked after. Whether you're planning an active itinerary or intending to relax on board, you are assured of a truly magical journey.

Enjoy a host of experiences, including a game of pétanque, admiring the passing scenery and savouring fine cuisine—and all at a leisurely, relaxing pace.

OUR INDIVIDUALLY DESIGNED BARGES offer spacious, luxurious facilities, including, on certain barges, heated swimming pools and sun decks with 360-degree views of the landscape.

DINING is a highlight of every cruise. With a highly skilled chef on board, you can look forward to gourmet delights, from tasty breakfasts and delicious lunches to five-course candlelit dinners.

Our chef sources the freshest ingredients from local markets and will tailor the cuisine to your tastes. You can also visit the markets with the chef. Your cruise begins in style with a champagne reception to welcome you on board. All meals, beverages and excursions are included in your fare.

EXCURSIONS are planned to suit your wishes. A personal guide is on board,

ready to introduce you to the region's highlights such as architectural landmarks or famous vineyards. An air-conditioned vehicle accompanies each barge for your onshore visits. Try out experiences such as hot-air ballooning, cycling or golf.

WHAT TO WEAR We recommend relaxed, informal attire during the day (flat heels are advised on deck).





STYLISH SPACES

Elegant luxury is the hallmark of our barges, providing roomy on-board living with all the creature comforts.

Our fleet allows you to discover France at a leisurely pace. Some of our barges have grand pianos, others heated, panoramic pools. Some are even decorated with antiques and stunning murals. And with cabin facilities such as iPod docking stations, DVD players, computers and Wi-Fi, this really is boating with a difference.

During the day you can relax in bright, airy lounges, gazing at the views through large picture windows, or soak up the vistas from the sun deck—also perfect for cocktails before dinner in the dining room. The spacious, air-conditioned cabins, most of which have oversized windows, and the sun deck areas enable you to enjoy the wealth of stunning views.

Each comfortable cabin has an en-suite bathroom, with either overhead shower or bath and shower, and a range of twin, double or king-size bed configurations.



Left and above: spacious decks offer the ideal place to relax and enjoy drinks as the world glides past.



HIGHLIGHTS OF FRANCE

Our barges cruise through Burgundy, along the mighty Rhône and the historic Canal du Midi in the Languedoc, passing swathes of stunning countryside and majestic cities such as Avignon and Dijon.



CANAL DU MIDI

Gems along the 150 mile-long canal, which stretches from Toulouse to the Mediterranean, include the magical hilltop town of Carcassonne, the Minervois wine region and ruggedly beautiful Corbières, famed for its Cathar castles. Rolling vineyards, fields of sunflowers and rows of plane trees create wonderful vistas and great walking and cycling opportunities.

PROVENCE

Sun-baked Provence, inspiration to poets and artists through the ages, offers an irresistible blend of lavender fields, dramatic gorges and vibrant market towns. Van Gogh found his muse in Arles, creating dozens of paintings here. Successions of Popes, meanwhile, were inspired by Avignon, home of their splendid summer base, the Palais des Papes.



SOUTHERN BURGUNDY

The region of Burgundy produces some of the world's finest wines, including the magnificent "Grands Crus". In the region's fun-loving wine capital, Beaune, you can marvel over the medieval Hôtel-Dieu with its multicoloured tiled roofs. To the north is Dijon, mustard capital of the world, with a fabulous market that lovers of fiery food should not miss.

NORTHERN BURGUNDY

The rolling countryside of this northern region is complemented by charming canals shaded with weeping willows and lined with delightful villages. Chablis is an historic town famed for its crisp, dry white wine. Visit the Abbey of Fontenay, a 12th-century monastery that is now a UNESCO World Heritage Site, and the battlefield of Alésia, where Julius Caesar's forces defeated the Gauls.

Clockwise from left: savour the tranquil waterways; the imposing town of Carcassonne; wine tasting in Burgundy; and lavender fields in Provence.

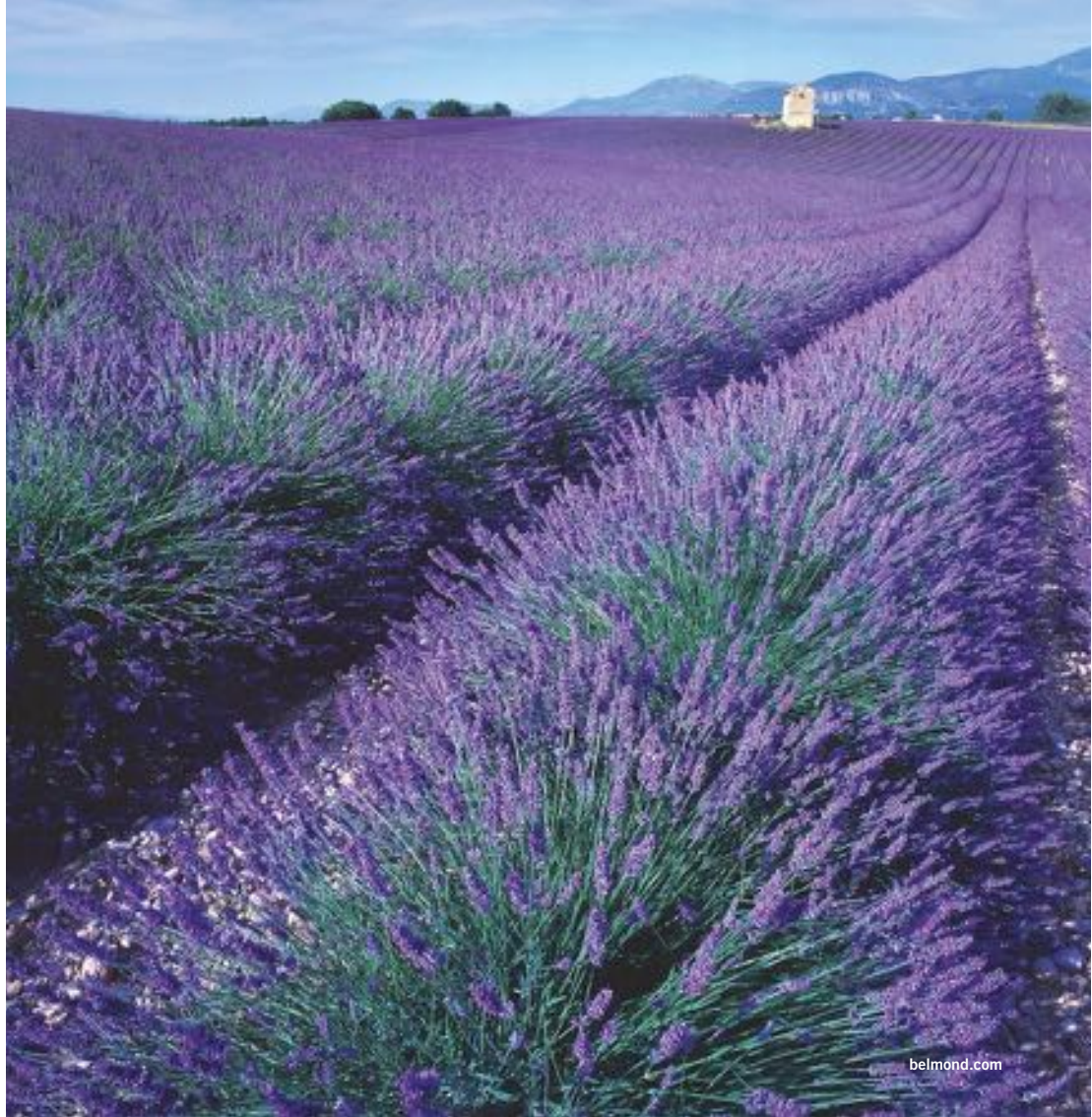

STEP ON BOARD

Read on to discover how each of our five luxury barges—**Belmond Alouette**, **Belmond Amaryllis**, **Belmond Fleur de Lys**, **Belmond Hirondelle** and **Belmond Napoléon**—can make cruising across the rivers and canals of the French countryside such a pleasure.



BELMOND ALOUETTE

CARCASSONNE to BÉZIERS

This is our most intimate barge, accommodating up to four guests on delightful cruises along the Canal du Midi.

Perfect for small groups or romantic holidays, Belmond Alouette offers two beautifully furnished cabins, each with an en-suite shower and double or twin beds. Guests can recline on comfortable sun beds on deck, or relax in the

spacious lounge/dining area, where there is a library, writing desk, stereo and games, and large picture windows framing the views. As with all our barges, a cordon bleu chef will create delicious menus for you using fresh local ingredients.

Available: Private hire.

Facilities: Lounge and dining area with TV, DVD player, selection of DVDs and CDs, HiFi system and Bose iPod docking station. Selection of books and board games. WiFi, computer with internet access. Sun deck with a 360° view, sun loungers, chairs, table and umbrella.

Technical specifications:

Total length: 100ft/30.48m.
Width: 15.58ft/4.75m. Decks: 1.
Crew: 4. Capacity: 4 passengers.

Deck 1



Deck 2

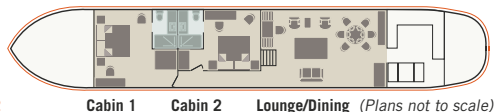

Left: Belmond Alouette on the Canal du Midi;
Right: relaxing on deck and luxurious accommodation.

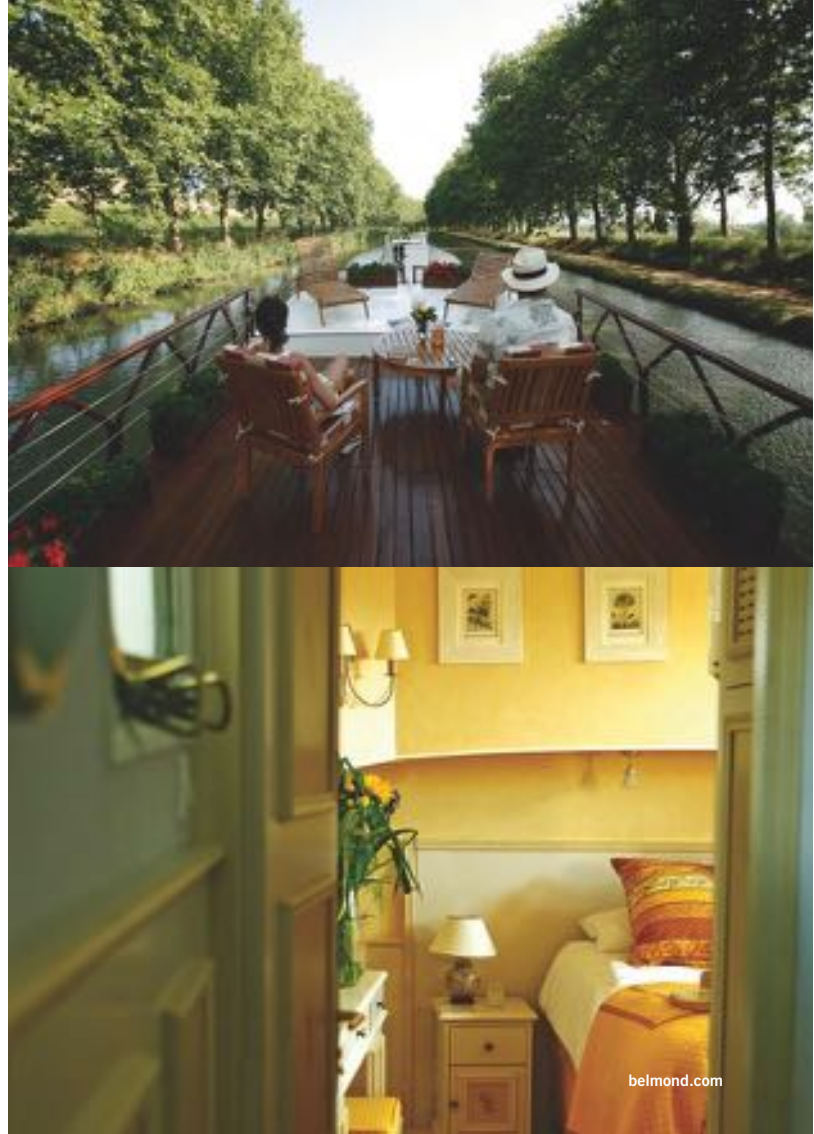

BELMOND AMARYLLIS

DIJON to ST-LÉGER

Carrying up to eight people in grand French style, our barge visits the beautiful cities, vineyards and villages of Burgundy.

Belmond Amaryllis exemplifies French finesse. Antique Louis XVI furniture, a trompe l'oeil wall mural, embroidered Parisian bedcovers and marble en-suite bathrooms create lavish but comfortable living areas. Four generous cabins offer king or twin beds. Sunny days can be whiled away in the heated pool on deck; dinner can be savoured in the formal dining room or in the lounge, with doors that span the width of the barge opening for some delightful alfresco dining.

Available: Private hire.

Facilities: Lounge with large windows, side-drawer cupboards, TV, DVD player, selection of DVDs and CDs, stereo surround-sound system and Bose iPod docking station. Selection of books and board games. WiFi, computer with internet access. Dining room. Sun deck with canopied area and a heated swimming pool.

Technical specifications:

Total length: 128ft/39m.

Width: 16.567ft/5.05m. Decks: 2.

Crew: 6. Capacity: 8 passengers.

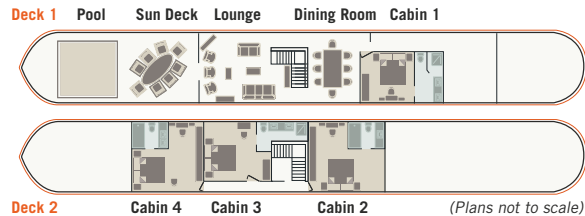

Right: Belmond Amaryllis is a stylish haven for eight.







BELMOND FLEUR DE LYS

DIJON to VANDENESSE-EN-AUXOIS

Offering an exotic flavour of India in the heart of Burgundy, this barge accommodates up to six guests.

With interiors enriched by authentic Indian furnishings, from ornate fabrics to four-poster beds, Belmond Fleur de Lys is a visual treat. Three spacious cabins each have en-suite bathrooms and dressing areas. Enjoy the panoramic vistas from the heated pool on deck or unwind in the air-conditioned lounge. Sumptuous dinners are served in the dining room, after which you can retire to the lounge and play the grand piano.

Available: Private hire.

Facilities: Lounge with large windows, grand piano, writing desk and chair, HiFi/stereo, WiFi, computer with internet access, TV, DVD player, selection of DVDs, CDs, books and games and Bose iPod docking station. Sun deck with a heated swimming pool.

Technical specifications:

Total length: 129ft/39.3m.

Width: 16.567ft/5.05m.

Decks: 2. Crew: 6.

Capacity: 6 passengers.

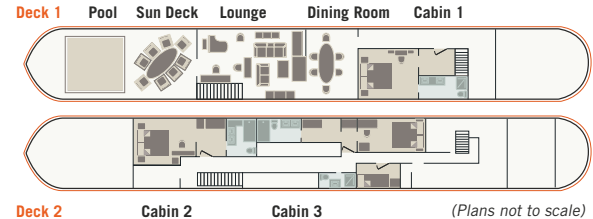

Admire the panoramic views while dining or relaxing in the heated pool on Belmond Fleur de Lys.



BELMOND HIRONDELLE

TANLAY to VENAREY

Eight passengers can enjoy the supreme comfort of this bright, airy barge, cruising among the grand châteaux and vineyards of Burgundy.

The soft décor of the recently refurbished Belmond Hirondeille complements the tranquil scenery outside. Four spacious cabins have oak-panelled ceilings and en-suite bathrooms. Two cabins can be configured as twins or doubles, one cabin is a fixed double, the other a fixed twin. Relax in the light-filled lounge or on the splendid teak deck beneath the canopy. Enjoy cooking classes with the chef in his kitchen or the option to attend private cookery lessons in a local chef's atelier.

Available: Private hire or per-cabin basis.

Facilities: A lounge and dining area with television, sound system, Bose iPod docking station, TV, DVD player, selection of books, games, DVDs and CDs. WiFi, computer with internet access. Sun deck with 360° views, deckchairs, two tables and a large canopy over part of the deck to provide a shaded dining area.

Technical specifications:

Total length: 129ft/39m.

Width: 16.56ft/5.05m.

Decks: 2. Crew: 5

Capacity: 8 passengers.

Deck 1 Sun Deck



Deck 2 Cabin 1 Cabin 2 Cabin 3 Cabin 4 Lounge Dining Area (Plans not to scale)



Right: Belmond Hirondeille's light-filled lounge and its teak deck, an ideal spot to admire the passing scenery.



STYLISH SPACES

Elegant luxury is the hallmark of our barges, providing roomy on-board living with all the creature comforts.

Our fleet allows you to discover France at a leisurely pace. Some of our barges have grand pianos, others heated, panoramic pools. Some are even decorated with antiques and stunning murals. And with cabin facilities such as iPod docking stations, DVD players, computers and Wi-Fi, this really is boating with a difference.

During the day you can relax in bright, airy lounges, gazing at the views through large picture windows, or soak up the vistas from the sun deck—also perfect for cocktails before dinner in the dining room. The spacious, air-conditioned cabins, most of which have oversized windows, and the sun deck areas enable you to enjoy the wealth of stunning views.

Each comfortable cabin has an en-suite bathroom, with either overhead shower or bath and shower, and a range of twin, double or king-size bed configurations.



Left and above: spacious decks offer the ideal place to relax and enjoy drinks as the world glides past.



BELMOND NAPOLÉON

TAIN to ARLES

With up to 12 passengers on board, our guests enjoy adventures through Provence along the River Rhône.

With its six sizeable cabins—each with an en-suite bathroom—stately lounge, generous deck and outdoor Jacuzzi, Belmond Napoléon is ideal for large, convivial gatherings. Enjoy cocktail parties under the stars, lavish feasts prepared by your talented private chef, time relaxing on the sun deck admiring the views, and visits to the region's multiple highlights, including its iconic wine estates.

Available: Private hire or per-cabin basis.
Facilities: Lounge with piano keyboard, a Bose iPod docking station, WiFi, computer with internet access, books, games, satellite TV, DVDs and CDs.

Dining room. Sun deck area with Jacuzzi, sun loungers and exercise bike, plus a large canopy over part of the deck to provide a shaded dining area.

Technical specifications:

Total length: 129ft/39.3m.

Width: 16.56ft/5.05m. Decks: 3.

Crew: 6. Capacity: 12 passengers.

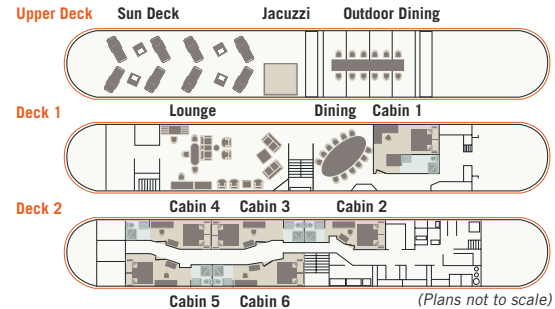

Belmond Napoléon offers attractive sights, a variety of activities and delicious cuisine.

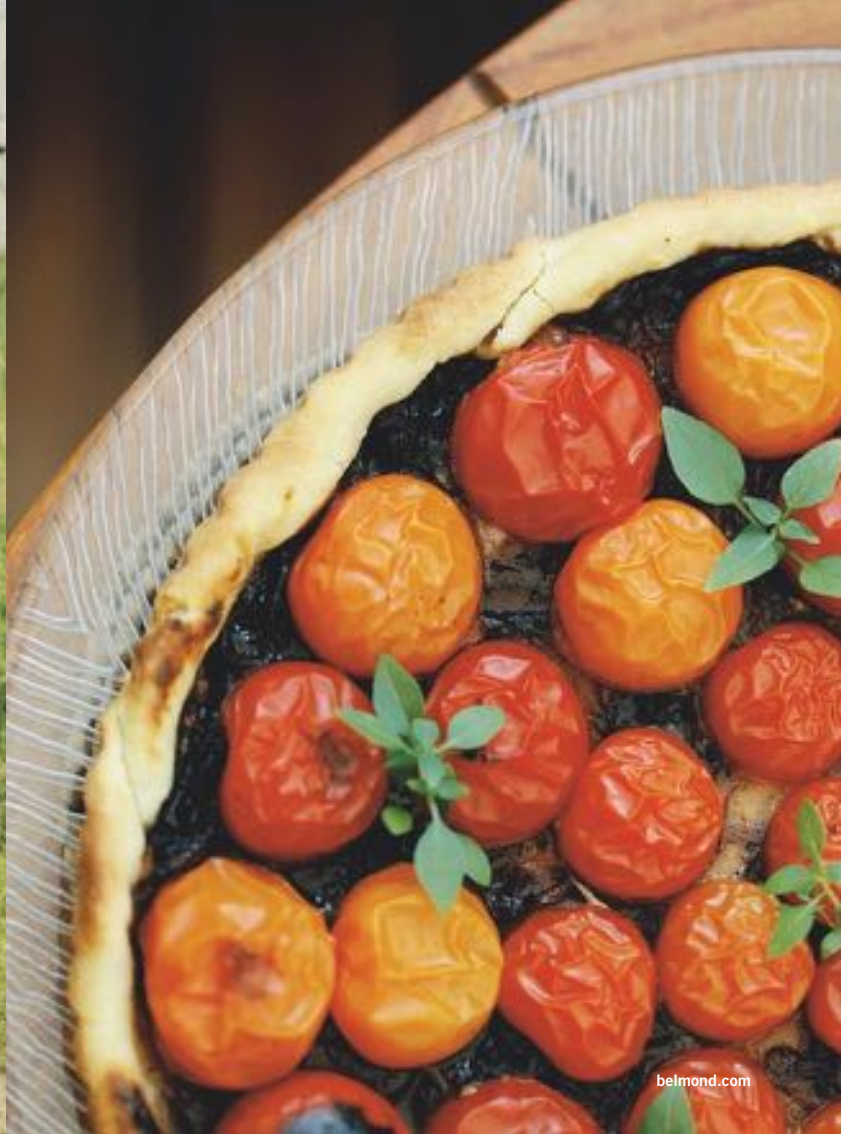



JOURNEYS TO REMEMBER

Read our sample **Inspiring Itineraries**, designed to give you a flavour of the wonderful experiences you can enjoy on a Belmond Afloat in France holiday. We can also customise your itinerary to discover France exactly the way you desire. Our **Special Interest Cruises** are perfect for families, food lovers and wine connoisseurs.

See our **Extend the Experience** options to combine your cruise with a memorable city break.

INSPIRING ITINERARIES

THE WONDERS OF PROVENCE

TAIN to ARLES

7 DAYS & 6 NIGHTS

This Provençal cruise includes visits to Viviers, Nyons, Avignon and Arles, and delicious wine, truffle and olive oil tastings.

Day 1 Board at Tain for a champagne reception.

Day 2 Cruise to medieval Viviers for a walking tour.

Day 3 Explore Nyons with your guide; visit a lavender distillery and 18th-century olive mill. Enjoy lunch in the stunning medieval town of Grignan. Stop at a truffle farm. Cruise to Roquemaure.

Day 4 Tasting of Châteauneuf-du-Pape wines. Cruise to Avignon, and stop at Pont du Gard.

Day 5 A walking tour of Avignon and the Palais des Papes. Afternoon visit to Les Baux.

Day 6 Discover Arles on foot, then lunch as you cruise to Vallabrègues. Visit St-Rémy and then enjoy olive oil tasting.

Day 7 Disembark after breakfast.

VENAREY-LES-LAUMES to TANLAY

7 DAYS & 6 NIGHTS

This cruise includes visits to Flavigny-sur Ozerain, the Cistercian Abbey of Fontenay and Chablis vineyards as well as private wine tastings.

Day 1 Board the barge in Venarey for a champagne reception and your first dinner.

Day 2 Visit medieval Flavigny-sur-Ozerain and the battle site of Alesia. Cruise to Montbard.

Day 3 Travel to the Forge de Buffon for a guided visit of the ironworks. After lunch on board, visit the Cistercian Abbey of Fontenay. Cruise to Ravières.

Day 4 Visit the medieval village of Noyers-sur-Serein. Afternoon cruise to Ancy-le-Franc.

Day 5 Visit Ancy-le-Franc Château and sail to Lezinnes.

Day 6 Cruise to Tanlay. Take a scenic drive around the Chablis vineyards. Lunch in a restaurant and private wine tasting.

Day 7 Disembark after breakfast.

Left: the impressive Pont du Gard. Right: the 12th-century Fontenay Abbey.



INSPIRING ITINERARIES

BEAUTY OF BURGUNDY

DIJON to ST-LÉGER

7 DAYS & 6 NIGHTS

This Burgundian cruise travels along two attractive canals and visits Beaune, the wine capital, and magnificent châteaux.

- Day 1** Board at Dijon's Port du Canal for a champagne reception.
- Day 2** Cruise the Canal de Bourgogne to Longecourt. After lunch, visit medieval Château du Clos de Vougeot.
- Day 3** Join a tour of Dijon. Visit the Ducal Palace, market and Maille mustard shop. Cruise along the River Saône to St-Jean-de-Losne.
- Day 4** Stop in Beaune, Burgundy's wine capital, and the Hôtel-Dieu, Hospices de Beaune. Joining the winding Canal du Centre, cruise to the picturesque village of Fragnes.
- Day 5** Head upstream. Enjoy walking and riding along the purpose-built cycle path. Visit Château de Rully. Dinner is in a fine local restaurant.
- Day 6** Cruise to St-Léger. Visit the 11th-century Château de Marguerite de Bourgogne in Couches. Enjoy a farewell dinner on board.
- Day 7** Transfer to Le Creusot for your onward travel.

CANAL DU MIDI

BÉZIERS to CARCASSONNE

7 DAYS & 6 NIGHTS

Glide along the beautiful Canal du Midi, enjoying visits to ancient villages, monasteries, markets and Europe's largest medieval fortress.

- Day 1** Enjoy a champagne reception party and dinner on board.
- Day 2** Morning trip to l'Abbaye de Fontfroide, an 11th-century Cistercian monastery. Cruise along to visit medieval Capestang, then continue to the charming Canal du Midi.
- Day 3** Explore the Oppidum d'Ensérune, a pre-Roman hilltop settlement, then sample some wine at a local vineyard.
- Day 4** Experience the art nouveau covered market in Narbonne and lunch in a superb local restaurant.
- Day 5** Visit Minerve, an old village perched on a limestone cliff. Return via Peyriac-Minervois for a wine tasting. The evening is spent moored at pretty Trèbes.
- Day 6** Arrive in Carcassonne with its massive medieval citadel. Farewell gala dinner on board.
- Day 7** Disembark after breakfast.

YOUR INTERESTS ARE OUR PASSION

Would you like to know more about wine? Or to dine on delicacies every day? Do you love the great outdoors, or architecture, or shopping? Let us create a **Special Interest Cruise** that incorporates your favourite pastimes, from haute cuisine to family fun.





SPECIAL INTEREST CRUISES

FOOD, GLORIOUS FOOD

France is renowned for its gastronomic excellence, so why not take the opportunity to treat your taste buds—with the help of our creative on-board chefs.

A highlight of each cruise is dining; our experienced chef, who prepares all your food using ingredients from the natural larders of Languedoc-Roussillon, Provence and Burgundy. Dinners are complemented by carefully chosen wines and delectable cheeseboards. You can even accompany Chef to market to choose sun-ripened, flavour-bursting foods for your menu.

Aboard both Belmond Alouette and Belmond Hirondele you can participate in cookery lessons in the open kitchen, mastering French specialties such as tarte au citron or “bourride”.

Or embark on epicurious adventures, including truffle-hunting and visiting artisan producers of Provençal oils and tapenades or the legendary Vin Jaune in the Jura.



SPECIAL INTEREST CRUISES

ENTERTAIN THE FAMILY

Canal cruising is excellent fun for all the family and, with stops to explore fairytale castles and adventure playgrounds, younger members are kept joyously entertained.

Combine child-friendly pursuits with adult activities on a customised cruise. On travels through Burgundy, for example, you can stop at La Rochepot to tour the magical 15th-century castle before visiting the Summer Bobsleigh Park in Le Creusot. Continuing to Rully, all the family can have tree-climbing fun at the ACCRO-Branchés outward-bound park. At Chalon you can try karting at an indoor circuit before strolling round the town’s antiques shops and half-timbered buildings. Horse-riding and cycling along the towpath are other fun activities, and children are always welcome in French restaurants—even Michelin-starred ones. On-board meals are crafted to suit even the most eclectic tastes, while entertainment from a magician rounds off an enchanting week.

Left: sample a fine vintage, look for tantalising ingredients with the on-board chef, or relax on deck.
Above: indulge in beautifully prepared desserts; keep the whole family entertained on a customised cruise.

SPECIAL INTEREST CRUISES

GRAPE ESCAPE

Indulge your passion for wine on a cruise through some of the world's most famous estates, visiting atmospheric cellars and vineyards and sampling legendary vintages.

Our Grands Crus cruise aboard Belmond Amaryllis is an exceptional experience for true connoisseurs. On this remarkable week-long journey, you will sample iconic wines from each of the 33 Grands Crus domains of Burgundy, including Clos de Vougeot and La Romanée-Conti. En route, you will meet winemakers, explore “caves” and vineyards not usually open to the public, and sit down to gastronomic dinners.

Our other barges also travel through great winelands. Enjoy tailored journeys to the renowned estates along the Canal de Bourgogne and the River Saône aboard Belmond Fleur de Lys. Travel through the heart of Provence on Belmond Napoléon to sample the famous Châteauneuf-du-Pape.

Or explore the famous Languedoc rosés courtesy of Belmond Alouette.

Right: a Beaune vineyard and Burgundy's renowned La Romanée-Conti.





CRUISE JOURNEY

LA SEMAINE DES GRANDS CRUS

ST-LÉGER-SUR-DHEUNE-DIJON

Day 1 Board Belmond Amaryllis for a champagne reception followed by an evening cruise to St Gilles. Dinner on board is hosted by a wine expert with tastings from Maison Joseph Drouhin.

Day 2 Cruise to Rully for private tours of Châteaux de Rully and Chamirey. A connoisseur will introduce you to local vintages at dinner.

Day 3 Sail to Chalon-sur-Saône for a special lunch in Puligny Montrachet. Dinner on board is accompanied by Grands Crus.

Day 4 Cruise to Saint-Jean-de-Losne and visit Beaune, capital of Burgundy's wine region, for a tour of the Hôtel-Dieu medieval hospital and see the Joseph Drouhin cellars. Christine and Philippe Drouhin-Laroze host dinner, introducing you to more wonderful wines.

Day 5 Sail to Longecourt and visit Clos de Vougeot, home of the Chevaliers du Tastevin. Dinner with Grands Crus tasting in the cellars of a private estate.

Day 6 After a walking tour and free time in Dijon, cruise into the Port of Dijon. Savour Burgundy's most renowned Grands Crus at the farewell dinner.

Day 7 Disembark after breakfast.

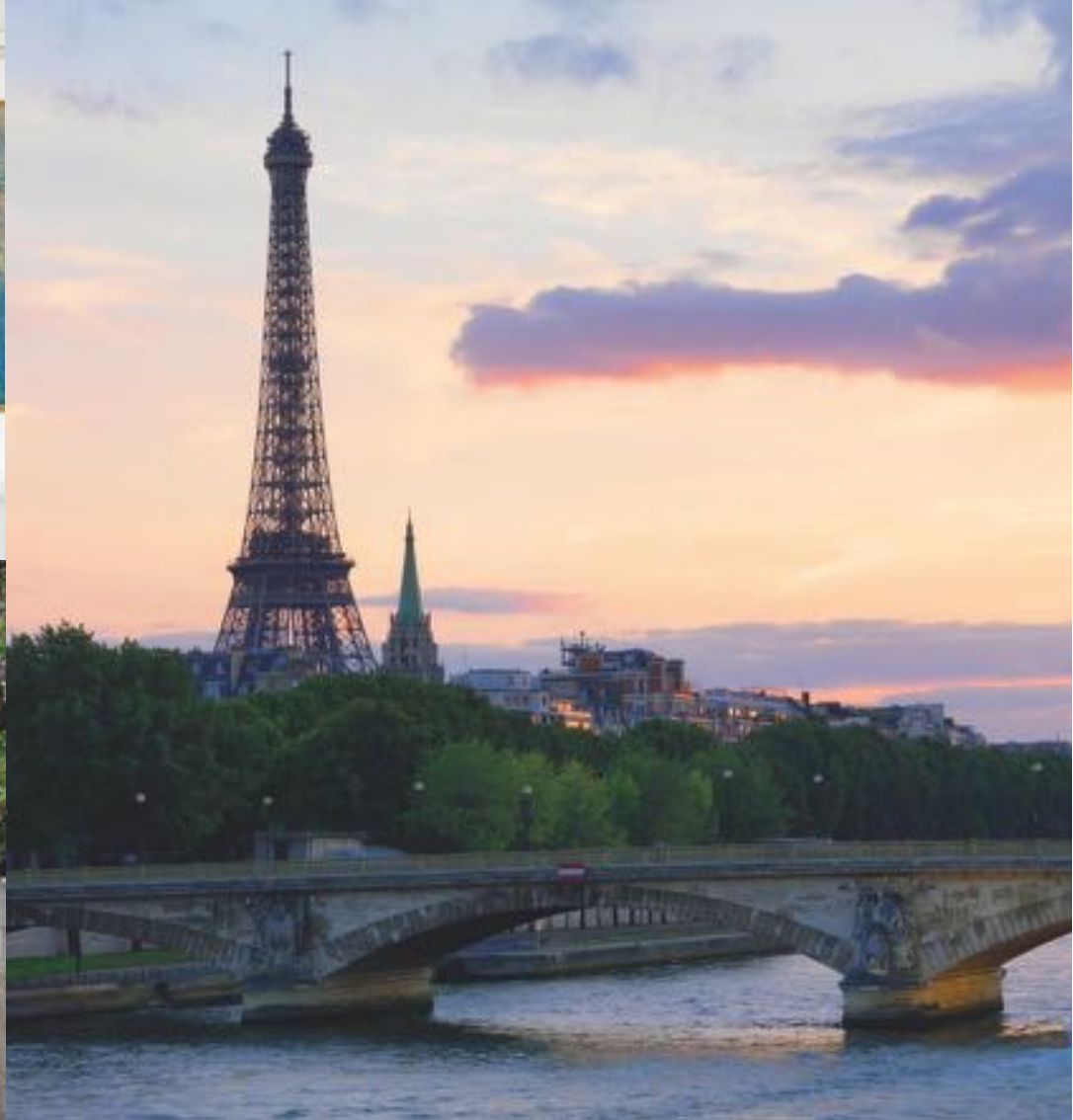

EXTEND THE EXPERIENCE

COMBINE A CRUISE WITH A CITY BREAK

Before or after your cruise, why not spend a few days in an exciting destination such as Paris, Nice, Bordeaux or Cannes? We can organise flexible tours with stays in superb hotels.

PARIS

Explore this romantic, vibrant capital at leisure while staying at the opulent Hôtel Le Meurice. Visit renowned attractions such as the Eiffel Tower, Louvre and Montmartre and Claude Monet's celebrated house and garden in Giverny, a short drive away. Back in Paris, you can admire his magnificent water-lily canvases in the wonderful Musée de l'Orangerie.

NICE

Stroll along the Promenade des Anglais, soaking up views of the palm-fringed bay and the charming ambience of this Côte d'Azur retreat. Explore the pretty Old Town with its bustling bars and compact galleries or visit one of the dizzying array of museums. Your hotel is the most famous in town—the flamboyant Le Negresco.

CANNES

Join the Riviera jet set in the town renowned for its glitzy film festival. People-watch on La Croisette, a curving promenade lined with luxury boutiques and home to the magnificent Hôtel Majestic Barrière, your base for the duration. Take a boat trip to Île Sainte-Marguerite, a rocky, pine-scented island with an impressive coastal fort.

BORDEAUX

Home to some of the most elegant streets in France, many of which are UNESCO-listed, Bordeaux is the wine capital of the world. Stroll within its Golden Triangle of magnificent boulevards and neoclassical buildings, then join the high-spirited locals at one of the many vibrant wine bars. Your base for your stay is the sumptuous Grand Hotel de Bordeaux & Spa.

From far left: the cobbled streets of Bordeaux; the Musée de l'Orangerie and the Eiffel Tower, both in Paris; Le Negresco hotel in Nice.

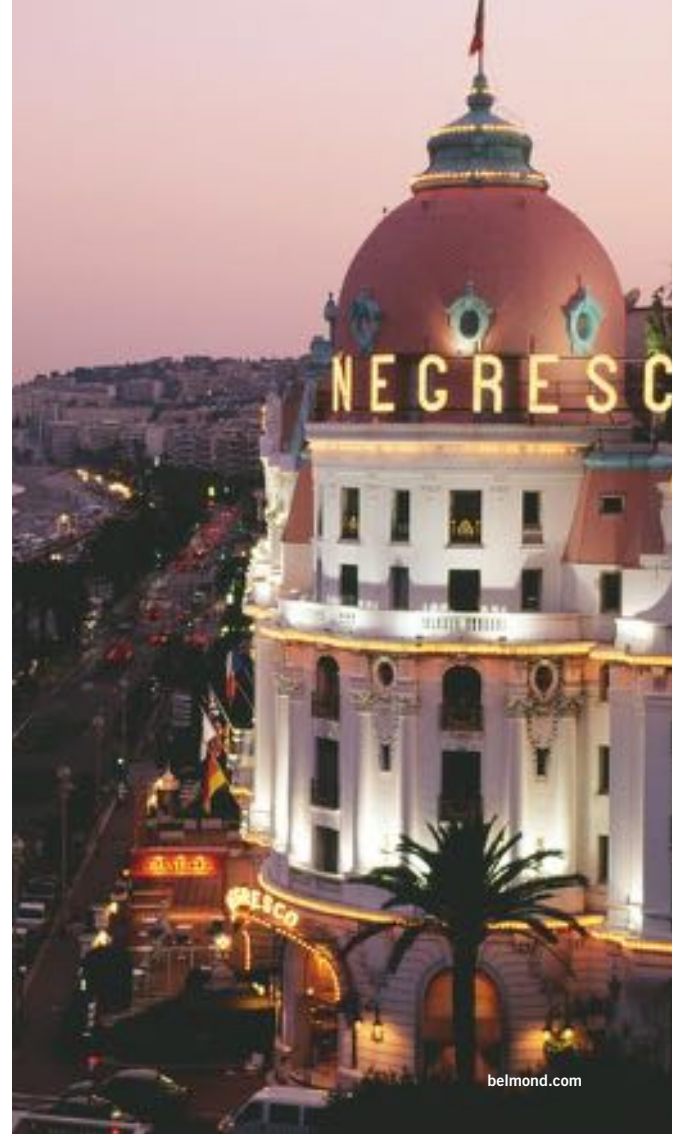



MORE JOURNEYS OF DISCOVERY

Explore thrillingly beautiful regions of Europe and Southeast Asia aboard
Belmond's luxurious trains and river cruisers.

Whether you wish to realise a lifetime's dream to travel on the Venice Simplon-Orient-Express, glide through the famous vineyards of Burgundy on a luxurious barge or soak up the majestic sights of Myanmar aboard an intimate cruise ship, Belmond's magnificent trains and river cruisers offer journeys to suit all tastes. Boasting exceptional staff, superb cuisine and a wealth of local knowledge, our travel experiences are designed to delight every guest. We invite you to explore our world.



TRAINS

VENICE SIMPLON-ORIENT-EXPRESS

Top of many travellers' must-do list is the legendary train, which whisks you back to the golden age of travel in its sumptuous art deco carriages. Journey to evocative destinations such as Venice, Prague, Stockholm and Istanbul or enjoy Inclusive Tours incorporating hotel stays in our Belmond hotels.

EASTERN & ORIENTAL EXPRESS

Coursing through rainforests, past mountains and paddy fields, this elegant train offers glorious journeys between Singapore and Bangkok, as well as taking you on more off-the-beaten-track experiences around Southeast Asia to royal cities, idyllic islands and highland tea plantations.

BELMOND BRITISH PULLMAN

Board the splendid 1920s carriages in London to embark on day and weekend trips to some of the UK's most enticing destinations. Dine on gastronomic cuisine, enjoy the silver service and fine wines as you travel to stately homes, castles, glorious gardens or great British sporting events.

BELMOND ROYAL SCOTSMAN

With just 36 passengers on board, this "country house on wheels" offers an idyllic way to explore the Scottish Highlands, combining glorious dining, private en-suite cabins, changing vistas and entertainment on board with engaging off-train activities such as golf or whisky tasting.

BELMOND NORTHERN BELLE

Travel in the style of the 1920s and 1930s aboard the vintage carriages of the Belmond Northern Belle, enjoying fine cuisine and wines and passing stunning scenery as you discover the best of Britain's cities, such as Bath, Chester and Cornwall, famous landmarks and major events.

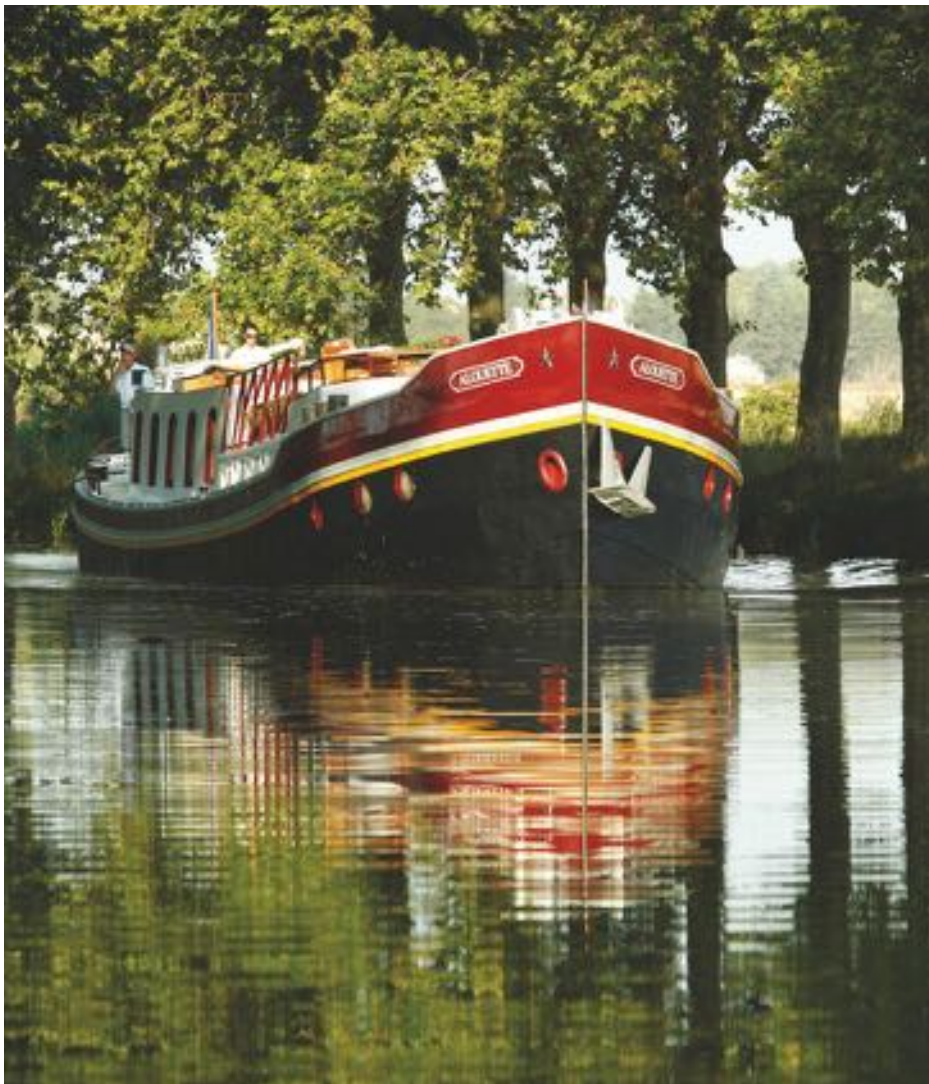

RIVER CRUISES

BELMOND ROAD TO MANDALAY

Visiting ancient temples, traditional villages and timeless landscapes, our majestic river cruiser carries you on mesmerising voyages through Myanmar. Exciting excursions introduce you to the country's marvels; life on board includes relaxation by the swimming pool and exhilarating entertainment in the evenings.

BELMOND AFLOAT IN FRANCE

Board one of our luxury barges to glide along the canals and rivers of Burgundy, down the mighty Rhône or along the picturesque Canal du Midi. Enjoy exclusive wine tastings, forays into fascinating cities, bike rides along sun-dappled towpaths or simply admire the scenery from the sun deck and on-board swimming pool.

BELMOND ORCAELLA

The sister ship of Belmont Road to Mandalay has its own swimming pool and takes only 50 passengers, offering leisurely cruising with an intimate feel on the Chindwin and Ayeyarwady Rivers in Myanmar. Venturing deeper into the country, you can visit remote monasteries, rural markets and local villages.