



ROAD TO MANDALAY

MYANMAR



ROAD TO MANDALAY

MYANMAR

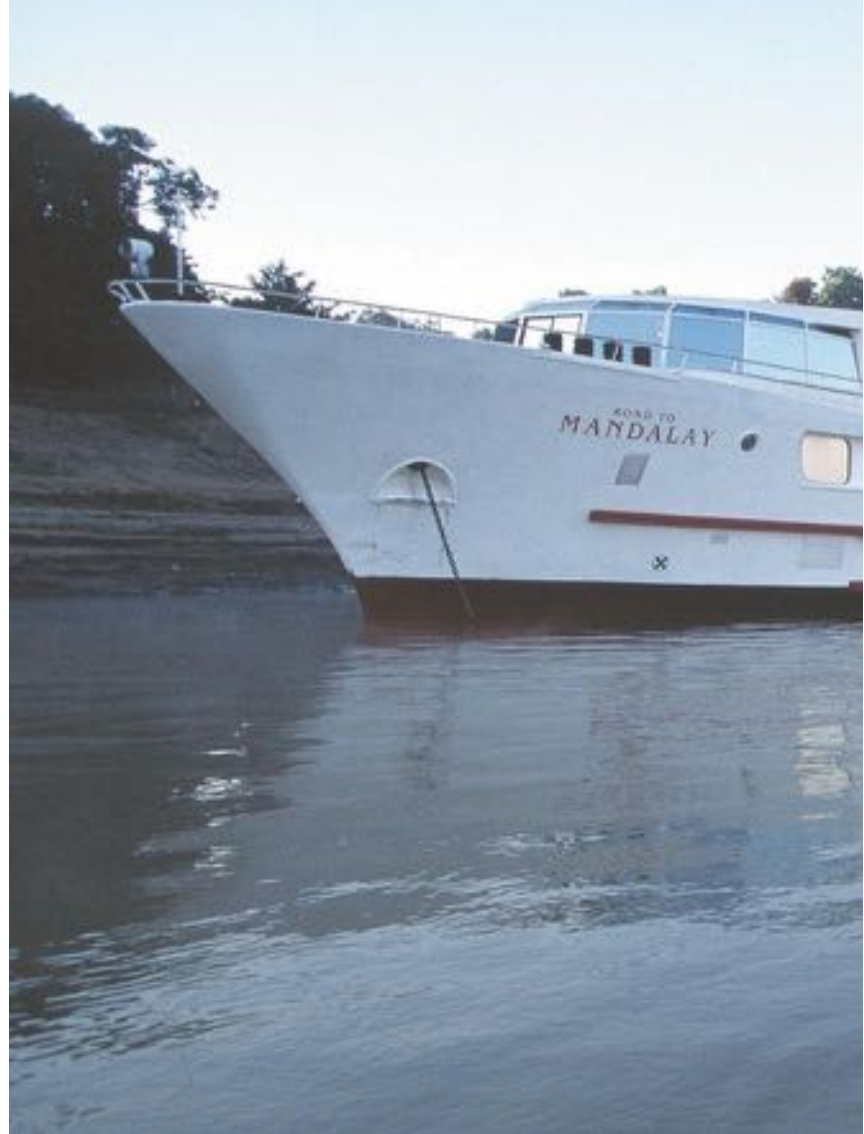





DISCOVER THE MAGIC OF MYANMAR

Cruise along the mighty Ayeyarwady River, passing Myanmar's most mesmerising landscapes, to explore fascinating ancient sites, visit timeless villages and meet wonderful local people.

Seemingly untouched by time, Myanmar is a land of golden pagodas and colourful festivals. Oxen graze on the riverbanks, saffron-robed monks process to revered shrines, children play in the shallows. All this and more can be absorbed from the decks of our luxurious river cruiser, Belmond Road to Mandalay. With 20 years' experience of operating in Myanmar, we have built an unrivalled wealth of expertise. Our journeys are a delightful blend of fascinating excursions to explore local life and on-board relaxation in spacious lounges or by the pool. The entire experience is enhanced by the friendly service of our peerless staff. Prepare for a voyage of a lifetime.

Left: the Kaunghmudaw Pagoda at Sagaing.
Right: novice monks in Myanmar.





SET SAIL ON A DREAM

There are many ways to experience river cruising with us, from cruise journeys to tailor-made Inclusive Tours with flights, transfers and luxury hotel stays all arranged for you.

WHERE Belmond Road to Mandalay gently cruises the Ayeyarwady River, stopping off at the country's awe-inspiring wonders, including the spectacular ancient city of **Bagan**, the royal capital of **Mandalay** and the sacred Sagaing Hills. Our Signature Journey, **Gorges of the Far North**, is an 11-night cruise that ventures to the far reaches of Bhamo, enabling guests to marvel at the scenic gorges that rear up from the Ayeyarwady River. In addition, we can arrange more extensive, customised journeys in Myanmar and Southeast Asia.

WHEN Join us between July and April and sail away on a choice of three-, four-, seven- or 11-night cruises.



HOW You can choose between two main experiences.

Cruise Journey: this features a journey aboard Belmond Road to Mandalay with internal flights between Yangon and the ship, transfers from the airport to the ship and vice versa, meals, excursions and guides included in the price of your fare.

Inclusive Tour: we can create tailor-made experiences for you, which include a cruise on our luxury river cruiser plus an exclusive lakeside or beach stay, or wider forays into Cambodia, Laos and Thailand, where we have magnificent Belmond hotels. We can organise sightseeing options or culturally themed stays in cities and resorts. All domestic flights, transfers and experienced guides are included.

Above: eye-catching stupas glisten in the sun at Inle Lake.

Right: share a romantic sunset beside the pool on our river cruiser.



NEW HORIZONS, FRESH EXPERIENCES

As the world glides past, enjoy fine dining, sensational scenery and the warm smiles of your crew. Every moment on board is to be treasured.

With cool, relaxing spaces in which to mingle, luxurious cabins and indulgent touches you will be assured of a great journey ahead. Life on board is an exciting but also relaxing experience; our guests become part of the family. The unobtrusive attention of our experienced and friendly staff welcome you from the moment you step on board. Add to that the amazing cuisine from our Executive Chef, daily on-board entertainment, topical lectures by local and international experts to cooking classes and yoga on deck, and you have an unforgettable experience. We are also the only river cruiser operating in the area with our own on-board doctor.

You'll find the perfect places to relax and dine on board our river cruiser. And for a memento of your journey, browse in our on-board boutique with its range of local crafts and jewellery.

THE BAR is the hub where you can enjoy pre-dinner aperitifs and spend easy evenings with fellow travellers sipping delectable cocktails and listening to the pianist.

THE OBSERVATION DECK is the perfect spot to watch river life. It has a swimming pool, bar and sun deck.

OUR RESTAURANT offers both Eastern and Western specialities. Choose from a breakfast buffet, enjoy themed lunches and sit down in the evening to gourmet dinners

with complimentary local beer, wine or choose from a list of fine wines.

OUR WELLBEING area offers a variety of massage treatments from manicures, pedicures as well as a hair wash and blow-dry service. There is also a fitness area equipped with state-of-the-art equipment.

WI-FI Two iPads can be borrowed from reception for use in the Observation Lounge where wi-fi is available.

ENTERTAINMENT ON BOARD

allows you to enjoy an interesting programme of local entertainment, from Burmese marionettes to classical dancers, and insightful lectures on Myanmar's fascinating culture. In addition, you can learn to tie a traditional *longyi* or apply *thanaka*, a beauty treatment used by local women to cool and tone their skin.

WE RECOMMEND that you wear resort clothing during the day and smart-casual attire for dinner.





ROOMS WITH A CHANGING VIEW

The stylish interior design combines comfort, elegance and exquisitely handcrafted local touches.



Our graceful river cruiser has been designed with passengers' comfort in mind, while reflecting local styles and materials in its elegant interiors. The cabins feature luxurious furnishings made by local artisans. Across four decks, there are five categories of cabins: Single, Superior, Deluxe and State Cabins, plus the lavish Governor's Suite, with its own butler service and sitting room. All cabins enjoy outward-facing windows—to make the most of the fantastic views—satellite TV, air-conditioning, generous closet space and spacious en-suite bathrooms with locally made soaps and an iPod docking station. Complimentary bottled water is replenished daily.

The luxurious cabins all have outward-facing windows and spacious en-suite bathrooms

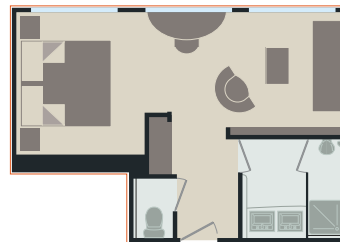

Governor's Suite



State Cabin

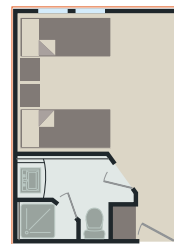

Deluxe Cabin



Superior Cabin



Single Cabin

Illustrations not to scale.



DISCOVER MORE

With our journeys, you don't simply cruise past the sights, we take you ashore so you can experience them.

Led by one of our team of on-board guides with exceptional local knowledge, you head inland to discover Myanmar's hidden treasures. And because you are in small groups, there is time to enjoy the sights at leisure. Meander around the ancient temples of Bagan, stopping to contemplate the breathtaking views. Wander through bustling markets and stroll past village teashops where the locals sip tea and enjoy sweet pastries. Discover a pretty village and engage in conversation with the residents. There are endless opportunities to explore and we are entirely flexible in tailoring to your needs. Such enlivening experiences are complemented by relaxing spells on board. Swim in the pool, sip a cocktail on deck, chat over the day's happenings with your fellow passengers. It's all part of the glorious adventure on Belmond Road to Mandalay.

Discover the culture of Myanmar with enlightening excursions and expert guides complemented by relaxation on board.





BAGAN

Your first sighting of this remarkable ancient city is breathtaking. Thousands of Buddhist temples are spread across a sun-baked plain, some vast and ornate, others in evocative ruins. Watching the sun set over the temples is mesmerising. You can even embark on a champagne sunrise balloon ride over Bagan to view this ancient site and its glistening pagodas. If you would like to linger longer, we can arrange a hotel.

MANDALAY

Myanmar's second largest city is its cultural and spiritual heartland and once the setting for King Mindon's magnificent court. Glimpse the old city along dusty lanes lined with teak houses. Sample an array of food at stalls and cafés in bustling Zegyo Market, and admire the view from Mandalay Hill, dotted with temples and pagodas.

THE PERFECT DESTINATION

Myanmar is bursting with exciting destinations. These are just some of the captivating places you can visit on your river cruise.

YANGON

The gateway to the country for most international visitors, Yangon offers an excellent introduction to Myanmar. Set on the Yangon River, this colourful city is a melting pot of diverse cultures and customs. It is home to the renowned, jewel-encrusted Shwedagon Pagoda, and to Belmond Governor's Residence, a tranquil garden hotel.

AYEYARWADY RIVER

The heart of Myanmar life is its main river, along whose mighty length unfold scenes of timeless cities, venerated shrines and day-to-day living. Small fishing boats jostle with barges, women lay out washing to dry, blooming shrubs give way to dense forest. Look out for kingfishers, egrets and the rare Ayeyarwady dolphin.

BHAMO

Reached by river through steep gorges and past dense jungle, Bhamo is an old trading port in the far north of Myanmar, close to the Chinese border. It bustles with merchants dressed in colourful attire and people from the nearby Shan, Kachin, Lisu and Palaung hill tribes, who come to trade in the popular market.

From left: heading to Bagan; children on the banks of the Ayeyarwady; a boat excursion.



YOUR JOURNEY STARTS HERE

Read on to discover more about **Our Signature Cruises**, **Cruise Journeys** and **Inclusive Tours** and be inspired to add a few extra days onto your trip with our **Explore and Discover** ideas, **Extend the Experience** suggestions and **Stay in Style** hotel recommendations.

Right: novice nuns in their distinctive pink robes.

OUR SIGNATURE CRUISE

GORGES OF THE FAR NORTH

MANDALAY-BHAMO-BAGAN

12 DAYS & 11 NIGHTS

A unique journey that provides an in-depth exploration of Myanmar, cruising from the city of Mandalay to Bhamo and finishing at the spellbinding temples of Bagan. This adventurous voyage provides you the opportunity to marvel at the gorges from the river.

Day 1 Fly from Yangon to Mandalay and transfer to the ship. Set sail for Mingun, where you visit the world's largest uncracked bell. Pre-dinner drinks party on board.

Day 2 Visit New Nyein to see traditional clay-pot making. Enter the first of three dramatic gorges around midday and steam past the picturesque island pagoda of Thihadaw.

Day 3 Stroll around the charming riverside village of Kyan Hnabt. Continue north towards the Colonial outpost of Katha, where the ship anchors at sunset.

Day 4 Follow in the footsteps of George Orwell and visit locations from his

Burmese Days, based on his time here in Katha. Have lunch in a Colonial House before sailing on upriver.

Day 5 Visit beautiful Shwe Paw Island in the morning. Sail through the second, most dramatic gorge before arriving at the market town of Bhamo.

Day 6 Visit Thein Pa Taung Meditation Centre, north of Bhamo. Return back through the second gorge.

Day 7 Head by private train into Kachin jungle and explore this beautiful habitat. Sail for the river port of Thabeikkyin.

Day 8 Take a breathtaking drive by local transport into the hills of Thabeikkyin to visit working elephants at a logging camp.

Day 9 Return to Mandalay, where you can explore the city on a tour.

Day 10 Set sail for Bagan and enjoy a sunset tour of the ancient city.

Day 11 Visit Bagan's temples. Tour to Mount Popa and its summit monastery.

Day 12 Return flight to Yangon.





CRUISE JOURNEY

AYEYARWADY ADVENTURE

MANDALAY-BAGAN-MANDALAY

8 DAYS & 7 NIGHTS

This journey commences in Myanmar's cultural capital, Mandalay, before continuing on to the temple-strewn plain of Bagan and the charming colonial town of Maymyo. This itinerary is also available starting and ending in Bagan.

Day 1 Fly from Yangon to Mandalay. Join Belmond Road to Mandalay, berthed by the village of Shwe Kyet Yet. After lunch on board, enjoy a tour of Mandalay's ancient palaces and religious shrines. Dinner and entertainment on board.

Day 2 Explore Ava, the ancient capital of Mandalay, by horse and cart before sailing to Bagan, enjoying a lecture on Burmese culture en route.

Day 3 Arrive in Bagan, a sun-drenched plain housing more than 2,000 ancient temples and pagodas. After a morning

orientation tour, you have the afternoon to explore further.

Day 4 Full-day excursion to Mount Popa, sacred home of the *nats* (spirits). Dinner and entertainment on board.

Day 5 In the morning, visit local markets or explore independently before sailing for Mandalay. On-board lecture and informal cocktail party before dinner.

Day 6 Enjoy a gentle walking tour of Mingun, home of the huge, unfinished pagoda of King Bodawpaya and the world's biggest uncracked bell. Lunch and dinner on board.

Day 7 Full day at the colonial hill station of Maymyo, known for its botanical gardens and horses and carriages. Enjoy the farewell gala dinner and entertainment on board.

Day 8 After an early breakfast, return by air to Yangon.



Left: painted Buddhas. Right: a fruit seller in Yangon market.



CRUISE JOURNEY

IMAGES OF A GOLDEN LAND

BAGAN-MANDALAY

5 NIGHTS & 4 DAYS

Explore the ancient temples of Bagan and the pagoda-topped hills of Sagaing, discover the ancient royal city of Mandalay, and visit Mingun, home of the world's largest ringing bell.

Day 1 Fly from Yangon to join Belmond Road to Mandalay. After lunch, enjoy a sightseeing tour of Bagan, a vast religious site of more than 2,000 temples. Dinner and entertainment on board.

Day 2 Set sail for Mandalay, enjoying an on-board lecture given by a local expert on Burmese customs, followed

by a casual cocktail party and delicious dinner.

Day 3 Enjoy a gentle walking tour of Mingun, home of the huge, unfinished pagoda of King Bodawpaya and the world's biggest uncracked bell. Lunch and dinner on board.

Day 4 Visit Mandalay and the Sagaing Hills with its beautiful pagodas and thriving community of Buddhist monks and nuns. Head to the teak U Bein Bridge for a sunset visit. Return for a farewell gala dinner on board.

Day 5 Return flight to Yangon.

Left: Bagan at sunrise. Opposite, from left: a bicycle with market produce; the U Bein Bridge on Taungthaman Lake.

CRUISE JOURNEY

HIGHLIGHTS OF MYANMAR

MANDALAY-BAGAN

4 DAYS & 3 NIGHTS

This shorter river cruise packs a punch with visits to the most revered sites of Mandalay, the former royal city, and the awe-inspiring temples of Bagan.

Day 1 Fly from Yangon to Mandalay to board Belmond Road to Mandalay. After lunch, enjoy a city tour, including a visit to the revered Mahamuni Paya. Dinner and local entertainment on board.

Day 2 Explore the ancient capital of Ava by traditional horse and cart in the morning and then set sail for Bagan, spending the day on the river.

Listen to a fascinating lecture on the Burmese way of life before joining fellow passengers for a relaxed cocktail party and dinner.

Day 3 Arrive in the celebrated ancient city of Bagan for an orientation tour of this remarkable area, where countless 11th-century temples and stupas are spread before you. After lunch you can explore independently or join our guided excursion. A delicious dinner and local entertainment is provided on board in the evening.

Day 4 Return flight to Yangon.





EXPLORE AND DISCOVER

HIGHLIGHTS OF YANGON

Before or after your cruise, let us arrange a stay for you in Myanmar's former capital Yangon—known as the “Garden of the East”. You can book one of our guided city tours below or we can create a bespoke itinerary exclusively for you.

Shwedagon Pagoda The shimmering, gilded and diamond-encrusted stupa of this magnificent sacred temple (left) can be seen from virtually anywhere in the city.

Bogyoke Aung San Market This is a bustling bazaar and fascinating treasure trove of wonderful lacquerware, woodcarvings, tapestries, silverware and jewellery.



EXTEND THE EXPERIENCE

GOLDEN ROCK

Intrepid travellers can go off the beaten path on a private extension to one of the country's most remarkable sacred sites.

For a rugged, exciting adventure, visit Golden Rock, a gold leaf-covered boulder topped with a pagoda on a cliff edge. This can be arranged as an overnight excursion from Yangon or extended to include more nights in the Southern Mon State region.

Above, left to right: traditional marionettes on sale at Bogyoke Aung San Market, Yangon; Golden Rock.

Right: the golden Shwedagon Pagoda, Yangon. Far right: Belmond Governor's Residence, Yangon.

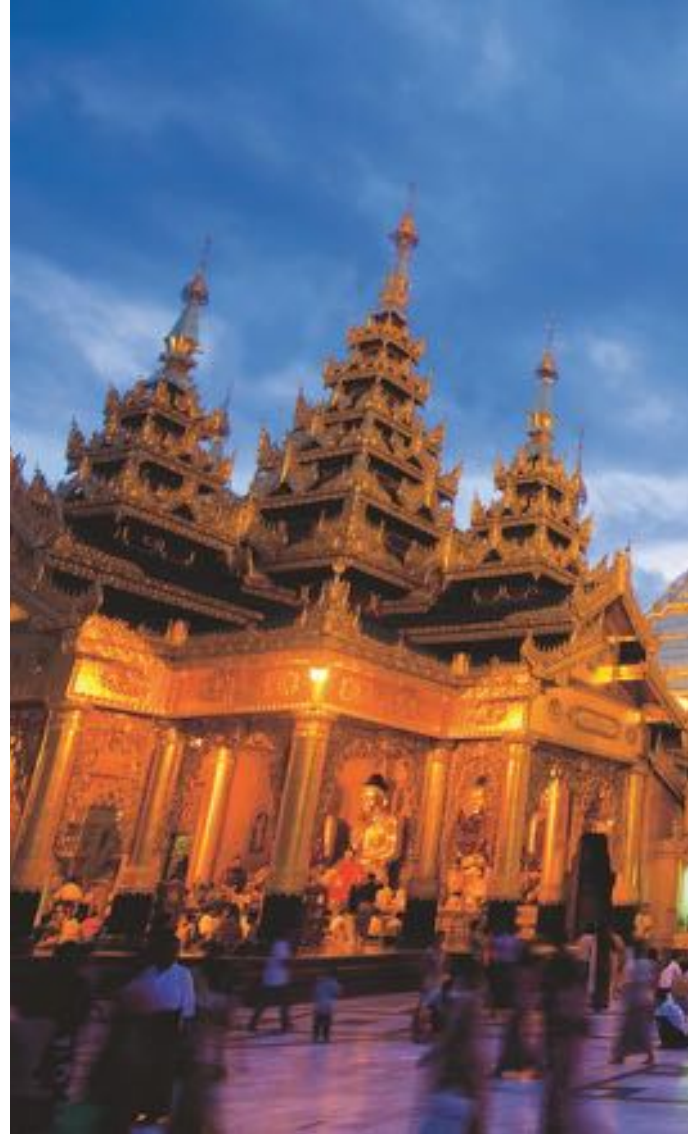



STAY IN STYLE

YANGON

To delve deeper into Myanmar, or to venture further afield, add one of our imaginative extensions to your cruise. If you're visiting Yangon, let us know how many days you would like to stay and we can organise a stay at our luxury hotel below.

BELMOND GOVERNOR'S RESIDENCE

Set within lush gardens, this colonial-style teak mansion is located in Yangon's leafy Embassy Quarter. At the end of a rewarding day, cool off in the fan-shaped pool, sip iced cocktails in the Kipling Bar and dine on Asian and European cuisine in the Mandalay Restaurant.





EXTEND THE EXPERIENCE

BEACH BREAKS

Combine your river cruise with a relaxing spell on a glorious beach in Ngapali, Koh Samui or Bali, and let us customise your itinerary so that you do as much or as little as you like. To make your experience more special, stay at one of our Belmond hotels.

NGAPALI

Myanmar's most famous and beautiful beach is totally unspoilt, which makes it the perfect place to relax under a palm tree or stroll along white, sandy beaches. Spend your days swimming or snorkelling in clear waters or go fishing. Indulge in spa treatments, sip cocktails and dine on fresh seafood. Ngapali makes a fitting finale to your Myanmar visit.

KOH SAMUI

A short flight from Bangkok, this lush Thai island is encircled by turquoise waters and pristine sands. Stay in a beautiful villa at **Belmond Napasai** to enjoy the private beach and palm-shaded gardens or to explore the natural wonders of Ang Thong National Marine Park, heading off for boat trips, kayaking and snorkelling, and views of the celebrated harbour.

BALI

This magical Indonesian island is renowned for its breathtaking sandy beaches and crystal-clear coves. Stay at **Belmond Jimbaran Puri**, where exquisite villas, each with a private pool, are scattered among frangipani trees beside one of the island's best beaches. Dine on the sands as the sun goes down for the ultimate indulgence.

STAY IN STYLE

NGAPALI

For a relaxing and memorable stay in Ngapali, choose from one of our carefully selected preferred hotels.

SANDOWAY BEACH RESORT

In a secluded setting among coconut palms beside Ngapali beach, this luxurious resort boasts beautiful two-storey villas and cottages dotted throughout its six acres of beach and lush gardens. The restaurant serves fresh seafood caught each morning.

AMARA OCEAN RESORT

Built in traditional style, 28 luxury bungalows are idyllically located in a palm grove overlooking the beach. Views of the Andaman Sea and Rakhine Mountains are breathtaking. The large terrace, together with the stunning pool and bar, overlooks the fascinating ocean.

Other recommended hotels

Ngapali Bay Villas & Spa
Aureum Palace Ngapali

Above from left: the beautiful, palm-fringed Ngapali beach; the sandy idyll at Belmond Jimbaran Puri; and the luxury Sandoway Beach Resort, Ngapali. Opposite page: golden Buddha statues in Pindaya Cave, seen on an excursion from Inle Lake; beside the lake itself; and Intha fishermen, known for their unique rowing style.



EXPLORE AND DISCOVER

OUT AND ABOUT

We can arrange a selection of wonderful excursions from Inle Lake, taking in any, or all, of the spellbinding destinations below.

Sagar In the southern part of Inle Lake is this amazing pagoda complex, including over 100 “sunken” stupas, submerged during high water.

Kakku For many years inaccessible, thousands of small pagodas have been restored by the hardworking Pa O people.

Pindaya Cave Deep in the hills is this cavernous maze filled with golden Buddha statues brought by pilgrims over the centuries.

Kalaw This former British hill station has colonial houses, a hospital, church and golf course.

Indaing Take a boat tour at the lake's western end and see farmers cultivating their produce.

Nyaung Shwe This thriving village north of Inle Lake is the area's main transport hub and includes a marina and popular market.



EXTEND THE EXPERIENCE

INTO THE HEART OF SHAN STATE

Escape to Myanmar's magical freshwater lake before or after your cruise and discover the area's scenic beauty and rich cultural heritage. We can arrange for you to visit one of the magnificent sights and stay at our suggested hotel.

INLE LAKE

This beautiful, highland lake in the Shan Plateau of eastern Myanmar is home to diverse ethnic groups, including the famous Intha leg rowers, who have a distinct style of rowing with one leg. The lake is renowned for its traditional floating villages, gardens and water hyacinth, while around the shoreline are ancient pagodas and monasteries, markets, artisan workshops and wildlife reserves. Our extensions include accommodation at the most deluxe lakeside resorts, your own personal guide, touring by boat, and all flights and transfers.



STAY IN STYLE

INLE LAKE

To make the most of tranquil and beautiful Inle Lake, make sure you stay at one of our carefully chosen hotels.

INLE PRINCESS RESORT

Located on the lake's eastern edge, Inle Princess Resort is a secluded retreat comprising a cluster of traditional wooden and bamboo chalets with tranquil views across the water and towards the blue-peaked Shan Hills. The restaurant serves wonderful Burmese and international favourites, and features the freshest, floating-garden produce.

Other recommended hotels

Villa Inle Resort
Aureum Palace Inle
Inle Lake View Resort



EXTEND THE EXPERIENCE

CULTURAL TOURS in CAMBODIA and LAOS

Combine your Myanmar adventure with an extension to Cambodia, home of the magnificent Angkor temple complex, or Laos and its ancient UNESCO World Heritage town of Luang Prabang.

CAMBODIA

One of Southeast Asia's smallest countries, Cambodia offers an intoxicating mix of magnificent architecture and unspoiled jungles and mountains. Its most famous draw is the fabled temple of Angkor Wat.

ANGKOR WAT

With more than 100 temples, shrines and pagodas, the world-renowned ancient capital of the Khmer Empire (800 to 1200AD) gives testament to that civilisation's amazing construction skills. The main Angkor Wat temple is awe-inspiring.

LAOS

Largely untouched by tourism, Laos boasts stunning landscapes and a rich cultural heritage. In the ancient town of Luang Prabang you will find highly decorative buildings among lush mountain scenery and fragrant gardens.

LUANG PRABANG

Surrounded by mountains and forests, the UNESCO World Heritage town in northern Laos, built by King Setthathirat in 1560, comprises both traditional Lao and European colonial buildings, decorated with dazzling paints, gilded stuccos and mirrored mosaics.

Above, from left: an artisan market in Luang Prabang; Laotian handmade paper umbrellas; the relaxing Belmond La Résidence Phou Vao; Right: Angkor Wat, Cambodia.

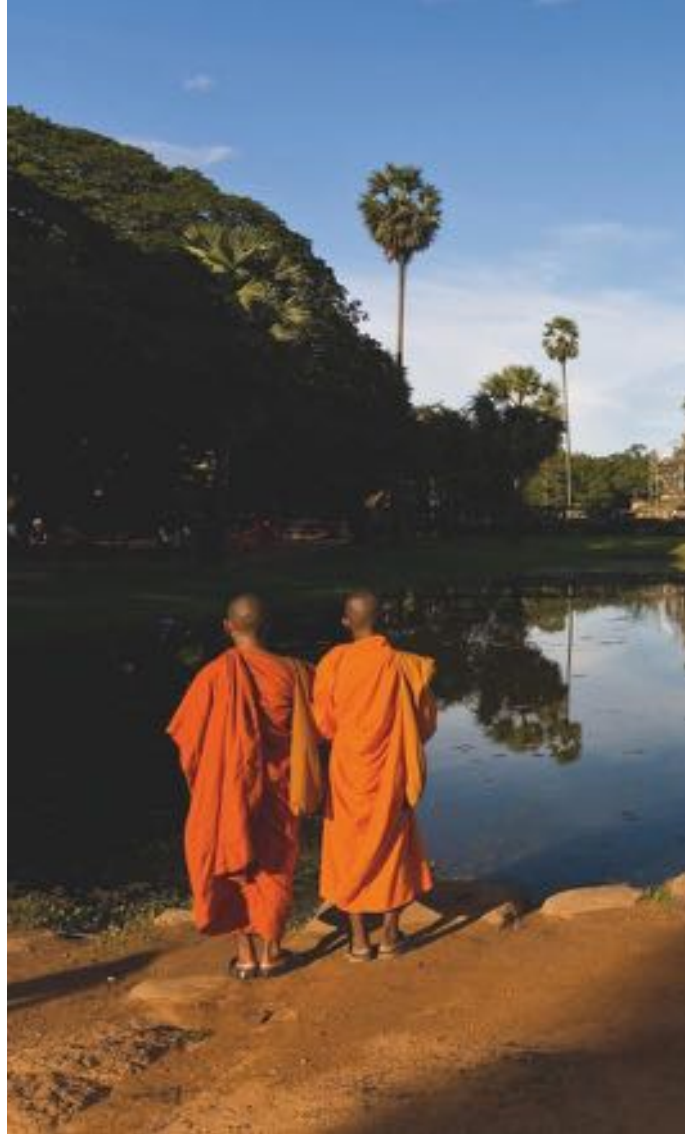



STAY IN STYLE

CAMBODIA and LAOS

BELMOND LA RÉSIDENCE D'ANGKOR

Stay at our intimate hotel on the banks of the Siem Reap River, close to the temples of Angkor. Amid lush gardens, its splendid Khmer architecture is furnished in local style and enhanced by modern and luxurious touches. Facilities include the Kong Kea Spa, a beautiful pool and two sumptuous restaurants.

BELMOND LA RÉSIDENCE PHOU VAO

Nestling on the Hill of Kites, overlooking the Mekong and Nam Khan rivers with stunning mountain views, our leafy hideaway feels like a country estate yet is minutes from the former royal city's markets and temples. Enjoy spacious suites, an infinity-edge pool, sumptuous spa and French and Laotian cuisine.



EXTEND THE EXPERIENCE

BANGKOK and SINGAPORE

Complement your relaxing river cruise with the bustle and excitement of the big city. Choose your city and let us know what you would like to see and how many days you would like to spend at our selected hotels opposite, and we will do the rest for you.

BANGKOK

Bangkok, capital of Thailand, is home to must-see attractions such as the Grand Palace, the Floating Market and the gigantic reclining Buddha. There are also lesser-known highlights to explore, including the Robot Building, the three-headed elephant statue and the so-called “David Beckham Temple”.

SINGAPORE

Vibrant Singapore is superlative for shopping—from the designer fashion stores along Orchard Road to the antique shops in Chinatown—but equally offers a delicious dining scene and stunning parks. Do not miss the futuristic “Supertrees” in the Gardens by the Bay.

Left: the “Supertrees” in Marina Bay, Singapore.
Right: Bangkok’s famous floating market.



STAY IN STYLE

RAFFLES HOTEL, SINGAPORE

This famous colonial-style, all-suite hotel (pictured above) has welcomed guests for over 100 years. Sip a Singapore Sling at the Long Bar before dining in the Raffles Grill.

THE ST REGIS, SINGAPORE

Located in the heart of the city and close to Orchard Road, the hotel also houses one of Asia's finest private art collections.

MANDARIN ORIENTAL, BANGKOK

Overlooking the Chao Phraya River, the hotel is renowned for its impeccable service, luxurious accommodation, superb cuisine and legendary spa.

THE PENINSULA, BANGKOK

Luxury meets sophisticated Thai charm at this "urban oasis on the river of kings". Enjoy exquisite riverside dining and a three-tiered pool.



VOYAGES BY LAND AND RIVER

For the ultimate Southeast Asian experience,
combine the best of both worlds of land and river
travel: our two river cruisers in Myanmar and our train.

The **Eastern & Oriental Express** travels between the dynamic cities of Singapore and Bangkok through the forested countryside of Malaysia and Thailand, blending unrivalled on-board comfort with intoxicating vistas of jungle-clad hills, ancient temples and lush paddy fields.

You can combine a journey on the train with a variety of cruises on either **Belmond Road to Mandalay** or her sister ship **Belmond Orcaella**, which glides along the Chindwin and Ayeyarwady Rivers with only 50 guests on board. Choose from

three- to 11-night cruises and add three to five nights travelling overland on the Eastern & Oriental Express. Stay at the leafy Belmond Governor's Residence in Yangon to catch your breath between adventures.

There is also the opportunity to extend your Asian experience further with hotel stays in destinations ranging from vibrant cities to blissful beach resorts.

Whatever combination you decide on, you can be certain of thrilling discoveries and unforgettable memories on this journey of a lifetime.

Embark on a never-to-be-forgotten adventure by combining your river cruise in Myanmar with an overland trip through Malaysia and Thailand on the Eastern & Oriental Express.

